



22 Charles Street ERSKINEVILLE NSW

 2  1

### Oh So Erskineville! Vendor says SELL!

Select a premier street, positioned just moments to Erskineville Village and Macdonaldtown Station and the vibrant King Street, then throw in a cute single storey terrace and you have a prime slice of inner city real estate. What a gem; located in a fabulous leafy street with a lovely original Victorian facade & private front courtyard. The floor plan features spacious lounge & dining room, two bedrooms, modern full bathroom & kitchen with internal laundry. Sunny paved courtyard opening directly out to the lovely open spaces of Burren Street playground. This home is also close to Sydney University and RPAH and offers excellent scope for further improvement. Co-Agent Davjomor Pty Ltd

Details David Moran 0418 170 860

[For full version visit the website](#)

**Type** : House  
**Land Size** : 120 sqm  
**View** : <https://www.selectproperty.net.au/8278253>

# 22 Charles Street Erskineville

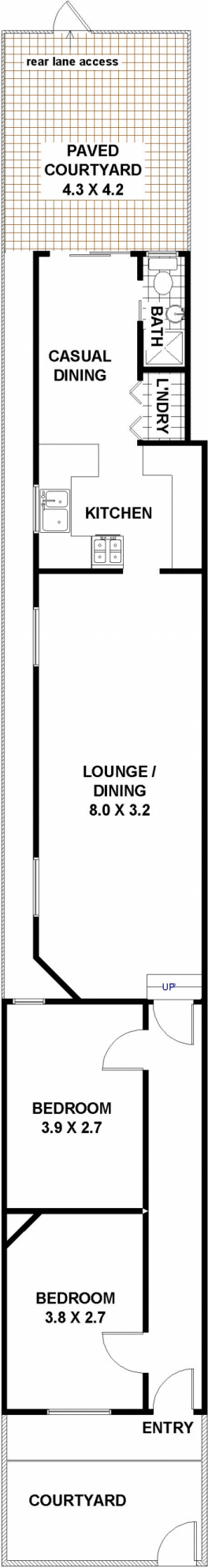

FLOOR PLAN  
ALL DIMENSIONS AND LAYOUT ARE APPROXIMATE ONLY.  
NO GUARANTEE OR LIABILITY WILL BE ACCEPTED FOR  
RELIANCE PLACED ON IT.